



B.Tech IV Semester Regular/Supplementary Examinations, July 2021

MACHINE DRAWING
(MECHANICAL ENGINEERING)

Maximum Marks: 70

Date:31.07.2021 Duration: 3 hours

Part-A

Answer any three questions carry equal marks (3x10M=30 Marks)

- 1 Draw the front and top view of an ISO threaded hexagonal bolt 150 mm long, 24 mm diameter and a thread length of 60 mm with a hexagonal nut. Indicate all the proportions and the actual dimensions.
- 2 Draw the sectional front, top and side view of a socket and spigot joint to join two pipes of diameter 35 mm each.
- 3 Draw the half sectional front view and right side of a bushed pin type flange coupling, indicating proportions to two shafts, each of diameter 30 mm.
- 4 Draw the full-sectional front view and top view of a single riveted single plate butt joint for plates of 15 mm thickness.

Part-B

Answer the following question (40M X 1=40Marks)

- 1 Assemble all the parts of screw jack shown in figure. Draw the following views
 - a) Half sectional view from the front
 - b) Top view.

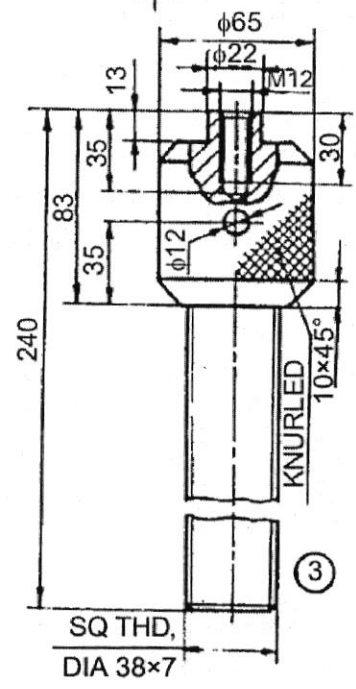
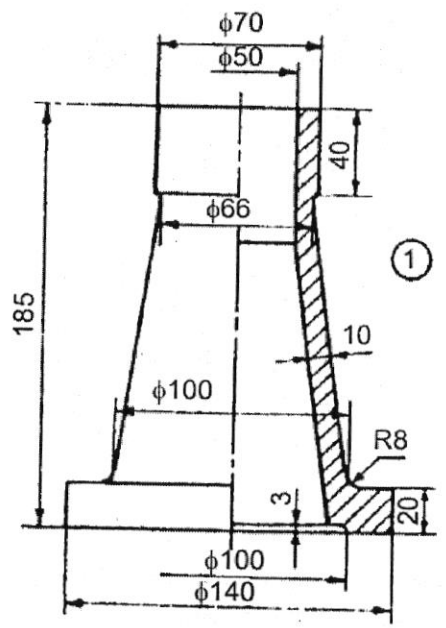
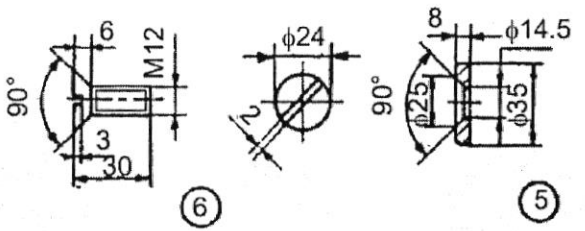
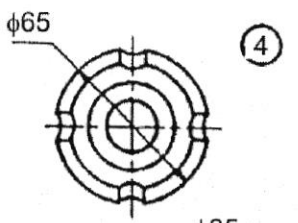
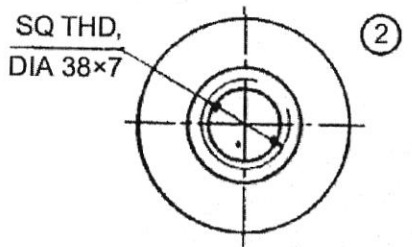
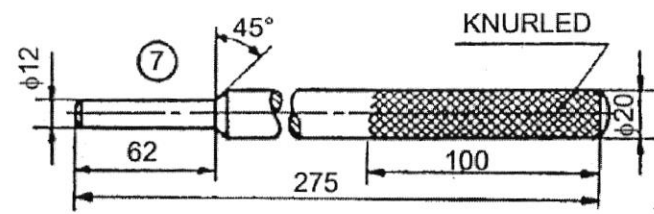
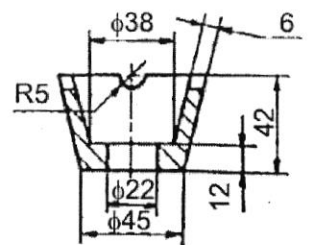
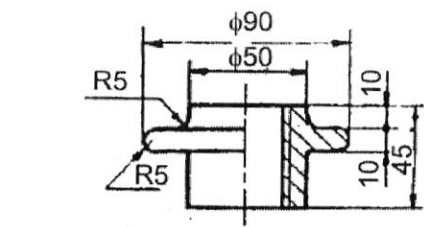

Parts list

Part No.	Name	Matl	Qty
1	Body	CI	1
2	Nut	GM	1
3	Screw	MS	1
4	Cup	CS	1
5	Washer	MS	1
6	Screw	MS	1
7	Tommy bar	MS	1